

Parcel Number 9023492		Ownership Name LA RENTAL LLC		Transfer of Ownership		Year 2024	Card 1
County Marion, IN	Township WAYNE	Date Dec 19, 2024	Grantor PQT RENOVATION LLC - Jan 01, 1900		Valid Y	Amount 0.00	Type Straight
Corporation		Date Jan 30, 2024	Grantor JETER, JOAN 1/5 INT & - Jan 01, 1900		Valid Y	Amount 0.00	Type Straight
District		Date Jan 29, 2024	Grantor Marion County Sheriff - Jan 19, 2024		Valid N	Amount 94000.00	Type Sale
Plat		Date Dec 03, 2021	Grantor JETER, JOAN 1/5 INT, - Jan 01, 1900		Valid Y	Amount 0.00	Type Straight
Map 0000000000	Address 5384 CULVER LN GREENWOOD, IN 46142--899						
Alt Parcel 49-06-33-152-047.000-901							
Property Class 510							
Tax District 901							
Neighborhood 915632076-9-156 -076							

Property Address
1102 N TREMONT ST
INDIANAPOLIS, IN 46222

Account 3151901
Book **Page**
Legal
CLARK'S ADDITION TO HAUGHVILLE L209

Topography
 Level
 High
 Low
 Rolling
 Swampy
Pub. Utilities
 Water
 Sewer
 Gas
 Electricity
Street or Rd.
 Paved
 Unpaved
 Proposed
 Sidewalk
 Alley
Neighborhood
 Improving
 Static
 Declining
 Other
 Blighted

VALUATION RECORD				
Assessment Year	2024	2023	2022	
Reason for Change				
Land	Homestead-C1	3,000	3,000	3,000
	Residential-C2	0	0	0
	Non-Residential-C3	0	0	0
	Total Land	3,000	3,000	3,000
Improvements	Homestead-C1	77,100	76,600	69,700
	Residential-C2	0	0	0
	Non-Residential-C3	0	0	0
	Total Imp	77,100	76,600	69,700
Total Assessed Value:		80,100	79,600	72,700

Property Sub Class: RES ONE FAMILY PLATTED LOT-510 PRINTED FROM MARION COUNTY, INDIANA

Memorandum

LAND DATA AND COMPUTATIONS										
Land Type	Actual Frontage	Effective Frontage	Effective Depth	Factor	Base Rate	Adjusted Rate	Estimated Value	Influence Factor	Land Value	
F-9	37	37	148	1.00	80.00	80.00	2960	0-	2960	
Acreeage / Sq. Ft.										
								Total Residential Land Value		3000
								Total Non-Residential Land Value		0
Total Acreeage				0.13	Total Land Value				3000	

- Land Type**
- F Front Lot
 - R Rear Lot
 - 1 Comm. Ind. Land
 - 11 Primary
 - 12 Secondary
 - 13 Undeveloped Usable
 - 14 Undeveloped Unusable
 - 2 Classified Land
 - 3 Undeveloped Land
 - 4 Tillable Land
 - 5 Non-tillable Land
 - 6 Woodland
 - 7 Other Farmland
 - 8 Ag Support Land
 - 81 Legal Ditch
 - 82 Public Road
 - 83 Utility Trans. Tower
 - 9 Homesite
 - 91 Res. Excess Acres
 - 92 Ag Excess Acres
 - Influence Factors**
 - 0 Other
 - 1 Topography
 - 2 Under Improved
 - 3 Excess Frontage
 - 4 Shape or Size
 - 5 Misimprovement
 - 6 Restrictions
 - 7 Traffic Flow
 - 8 View
 - 9 Corner Infl.

SKETCH/AREA TABLE ADDENDUM

Parcel Number
9023492

Year 2024 Card 1

Property Address
1102 N TREMONT ST

SKETCH/AREA TABLE ADDENDUM

AREA CALCULATIONS SUMMARY

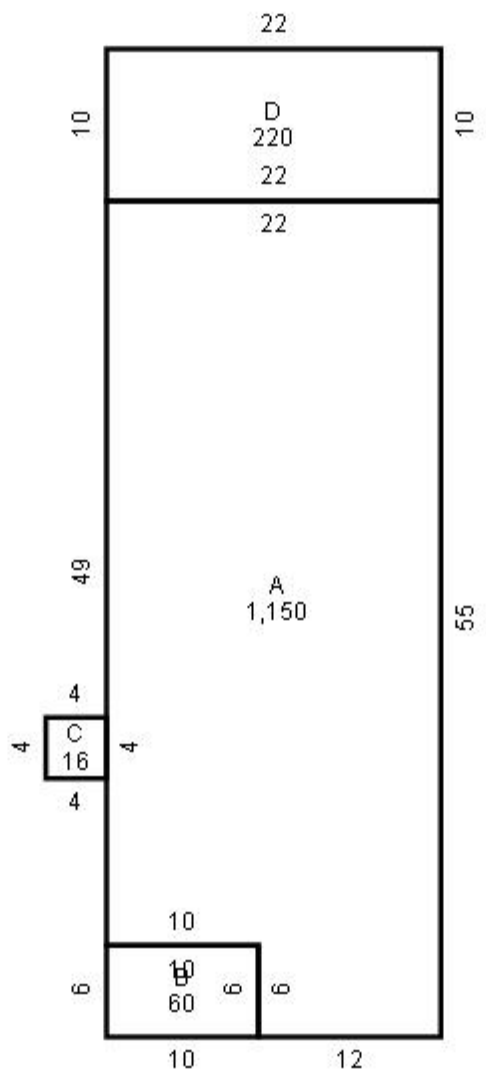

Name	Description	Size (Sqft)
	Total Sqft.	