

Parcel Number 6001704		Ownership Name		Transfer of Ownership		Year 2020	Card 1
County	Marion, IN	STAR VENTURES REAL ESTATE INC		Date	Grantor	Valid	Amount
Township	PIKE			May 14, 2018	Johnson, President Brian - May 11, 2018	N	1.00
Corporation				May 15, 2018	THREE MILE PROPERTIES INC - Jan 01, 1900	Y	0.00
District				Sep 21, 2016	Bzezinski, Personal Rep Holly - Sep 14, 2016	N	350000.00
Plat				Sep 21, 2016	RYAN, LINDA D - Jan 01, 1900	Y	350000.00
Map	09331-00-003-0	Address		Nov 26, 2014	Ryan Linda D - Nov 19, 2014	N	45000.00
Alt Parcel	49-04-21-101-019.000-600	8925 PRAIRIE TRL		Aug 14, 2013	RYAN, ROBERT C & LINDA D - Jan 01, 1900	Y	0.00
Property Class	450	AVON, IN 46123--908					
Tax District	600						
Neighborhood	6450307-6-450-c07						

Property Address
8562 LAFAYETTE RD
INDIANAPOLIS, IN 46278

Topography	Pub. Utilities	Street or Rd.	Neighborhood
<input checked="" type="checkbox"/> Level	<input checked="" type="checkbox"/> Water	<input checked="" type="checkbox"/> Paved	<input type="checkbox"/> Improving
<input type="checkbox"/> High	<input checked="" type="checkbox"/> Sewer	<input type="checkbox"/> Unpaved	<input type="checkbox"/> Static
<input type="checkbox"/> Low	<input checked="" type="checkbox"/> Gas	<input type="checkbox"/> Proposed	<input type="checkbox"/> Declining
<input type="checkbox"/> Rolling	<input checked="" type="checkbox"/> Electricity	<input type="checkbox"/> Sidewalk	<input checked="" type="checkbox"/> Other
<input type="checkbox"/> Swampy	<input type="checkbox"/>	<input type="checkbox"/> Alley	<input type="checkbox"/> Blighted

Account		2689230	Assessment Year		2020	2019	2018
Book		Page	Reason for Change				
Legal		MINNEHAHA ADD L3	Land	Homestead-C1	0	0	25,700
				Residential-C2	0	0	0
				Non-Residential-C3	189,100	189,100	24,700
				Total Land	189,100	189,100	50,400
			Improvements	Homestead-C1	0	53,400	59,100
				Residential-C2	0	0	0
				Non-Residential-C3	290,900	0	0
				Total Imp	290,900	53,400	59,100
Total Assessed Value:					480,000	242,500	109,500

VALUATION RECORD

Property Sub Class: COM CONVENIENCE MARKET/GAS-450 PRINTED FROM MARION COUNTY, INDIANA

Memorandum

CHANGED GRADE TO D PER 18/19 CYCLICAL REASSESSMENT.

LAND DATA AND COMPUTATIONS

Land Type	Actual Frontage	Effective Frontage	Effective Depth	Factor	Base Rate	Adjusted Rate	Estimated Value	Influence Factor	Land Value
			Acreage / Sq. Ft.						
11			87120		4.00	4.00	348480	0 : 50	174240
14			165628		0.09	0.09	0		14900
Total Acreage			5.80	Total Land Value			189100		

Land Type

- | | |
|--------------------------|-------------------------|
| F Front Lot | 81 Legal Ditch |
| R Rear Lot | 82 Public Road |
| 1 Comm. Ind. Land | 83 Utility Trans. Tower |
| 11 Primary | 9 Homesite |
| 12 Secondary | 91 Res. Excess Acres |
| 13 Undeveloped usable | 92 Ag Excess Acres |
| 14 Undeveloped Unusable | |
| Influence Factors | |
| 2 Classified Land | 0 Other |
| 3 Undeveloped Land | 5 Misimprovement |
| 4 Tillable Land | 1 Topography |
| 5 Non-tillable Land | 2 Under Improved |
| 6 Woodland | 3 Excess Frontage |
| 7 Other Farmland | 4 Shape or Size |
| 8 Ag Support Land | 5 Corner Infl. |
| | 6 Restrictions |
| | 7 Traffic Flow |
| | 8 View |

Roof Type
BUILT-UP

Walls

Frame or equal	<input type="checkbox"/>	<input type="checkbox"/>	<input type="checkbox"/>	<input type="checkbox"/>
Brick or equal	<input checked="checked" type="checkbox"/>	<input type="checkbox"/>	<input type="checkbox"/>	<input type="checkbox"/>
Metal or equal	<input type="checkbox"/>	<input type="checkbox"/>	<input type="checkbox"/>	<input type="checkbox"/>
Open	<input type="checkbox"/>	<input type="checkbox"/>	<input type="checkbox"/>	<input type="checkbox"/>

Framing

Wood Joist

Fire Resistant	<input type="checkbox"/>	<input type="checkbox"/>	<input type="checkbox"/>	<input type="checkbox"/>
Fireproof Steel	<input type="checkbox"/>	<input type="checkbox"/>	<input type="checkbox"/>	<input type="checkbox"/>
Reinf. Concrete	<input checked="checked" type="checkbox"/>	<input type="checkbox"/>	<input type="checkbox"/>	<input type="checkbox"/>

Flooring

Softwood

Hardwood	<input type="checkbox"/>	<input type="checkbox"/>	<input type="checkbox"/>	<input type="checkbox"/>
Parquet	<input type="checkbox"/>	<input type="checkbox"/>	<input type="checkbox"/>	<input type="checkbox"/>
Carpet	<input type="checkbox"/>	<input type="checkbox"/>	<input type="checkbox"/>	<input type="checkbox"/>
Unfinished	<input type="checkbox"/>	<input type="checkbox"/>	<input type="checkbox"/>	<input type="checkbox"/>
Other	<input type="checkbox"/>	<input type="checkbox"/>	<input type="checkbox"/>	<input type="checkbox"/>

Finish Type

Unfinished

Semifinished	<input type="checkbox"/>	<input type="checkbox"/>	<input type="checkbox"/>	<input type="checkbox"/>
Finished Open	<input type="checkbox"/>	<input type="checkbox"/>	<input type="checkbox"/>	<input type="checkbox"/>
Finished Divided	<input checked="checked" type="checkbox"/>	<input type="checkbox"/>	<input type="checkbox"/>	<input type="checkbox"/>

Heating & Air Conditioning

No Heating

Central Warm Air	<input type="checkbox"/>	<input type="checkbox"/>	<input type="checkbox"/>	<input type="checkbox"/>
Hot Water or Steam	<input type="checkbox"/>	<input type="checkbox"/>	<input type="checkbox"/>	<input type="checkbox"/>
Unit Heating	<input type="checkbox"/>	<input type="checkbox"/>	<input type="checkbox"/>	<input type="checkbox"/>
Central Air	<input checked="checked" type="checkbox"/>	<input type="checkbox"/>	<input type="checkbox"/>	<input type="checkbox"/>
Package or Unit Air	<input type="checkbox"/>	<input type="checkbox"/>	<input type="checkbox"/>	<input type="checkbox"/>
Sprinkler	<input type="checkbox"/>	<input type="checkbox"/>	<input type="checkbox"/>	<input type="checkbox"/>

Plumbing # TF

Full Baths		
Half Baths		
Extra fixtures		
Total	0	

Other Fixtures

Wash Fountains	G/F	ES	SS
Circular 36"			
Circular 54"			
Semi-circular 36"			
Semi-circular 54"			

Industrial Gang Sinks

4' long, 4 man			
8' long 8 man			

Shower-Column

Circular, 5 per			
Semi-circular, 3 per			
Corner, 2 per			

Shower Multi-Stall

Circular, 5 per			
Semi-circular, 3 per			
Corner, 2 per			

#Fixtures			
Gang Shower Heads			
Drinking Fountains			
Refrigerated Water Coolers			
.....with Hot & Cold Water			
Emergency Shower			
Eye Wash			

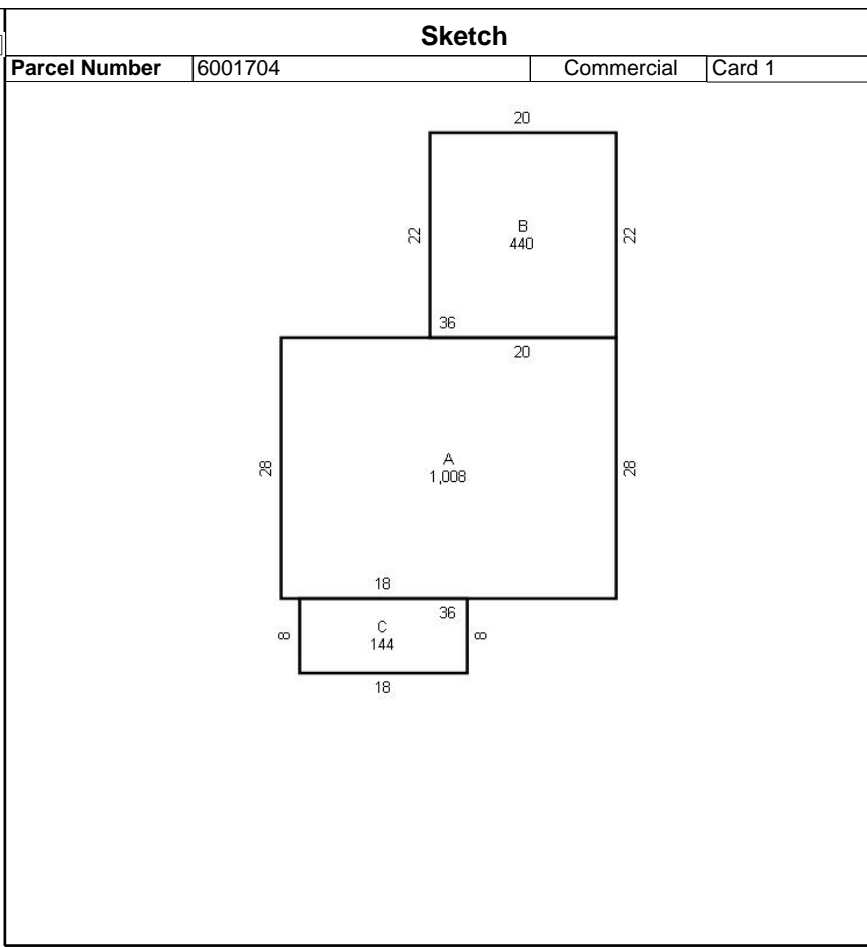

Use	M:Convenienc								
Pricing Key	GCM								
S.F. Area	3300								
Effective Perimeter L/F	234								
P.A.R	7								
Average Size / Units	3300 / 1	/	/	/	/	/	/	/	/
Section Level	HT. RATE	HT. RATE	HT. RATE	HT. RATE	HT. RATE	HT. RATE	HT. RATE	HT. RATE	HT. RATE
1	12 94.88								
Frame / PE Adj. [+ -]	11.70								
Wall Ht. Adj. [+ -]	0.00								
BASE PRICE	106.58								
B.P.A. %	1.00								
Sub-total	106.58								
Ceiling	0.00								
Interior Finish	0.00								
Division Walls	0.00								
Lighting	0.00								
Heating/Air Cond.	0.00/0.00	/	/	/	/	/	/	/	/
Sprinkler	0.00								
S.F. Price	106.58								
Area	3300								
Sub-total	351710								
Plumbing									
Unit Finish									
Special Features									
Exterior Features									
TOTAL BASE	351710								
Grade Factor	1.00								
Location Multiplier	1.00								
Reproduction Cost	351710								
Phys Dep/ Yr Blt /Cond	80 / 0 / A	/ /	/ /	/ /	/ /	/ /	/ /	/ /	/ /
Obsolescence	0								
Remainder Value	70340								

SUMMARY OF IMPROVEMENTS

Use	Ht.	Const Type	Grd	Year Const	Effvt Year	Cnd	Base Rate	Feat	Adj Rate	No. Un.	Size or Area	LCM	Rpic Cost	Dep Obs	REM Val	% Cmp	Trend Factor	True Tax Value	Val. Adj. / Sound Val.
Building											3300	1.00			70340	100	108	76000	
Paving -Conc	6	Hvy	C	2019	2019	A	4.75	1	4.99	1	32533	1.00	162340	8/	149350	100	108	161300	
Canopy	0	Average	C	2019	2019	A	25.94	0	25.94	1	25x85	1.00	55120	10/	49610	100	108	53600	

SUMMARY OF SPECIAL FEATURES / EXTERIOR FEATURES

Card Improvement Total	290870
Total Improvement Value	290870

SKETCH/AREA TABLE ADDENDUM

Parcel Number
6001704

Year 2020 **Card 1**

Property Address
8562 LAFAYETTE RD

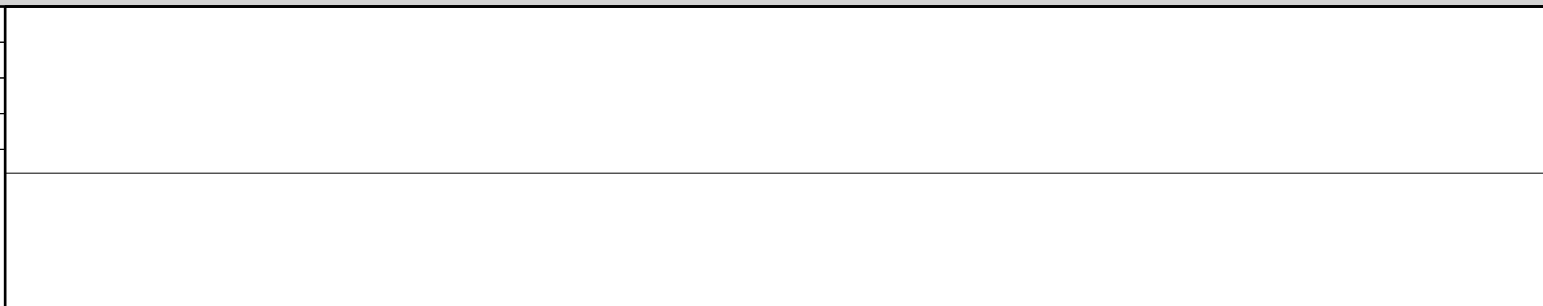

SKETCH/AREA TABLE ADDENDUM

AREA CALCULATIONS SUMMARY

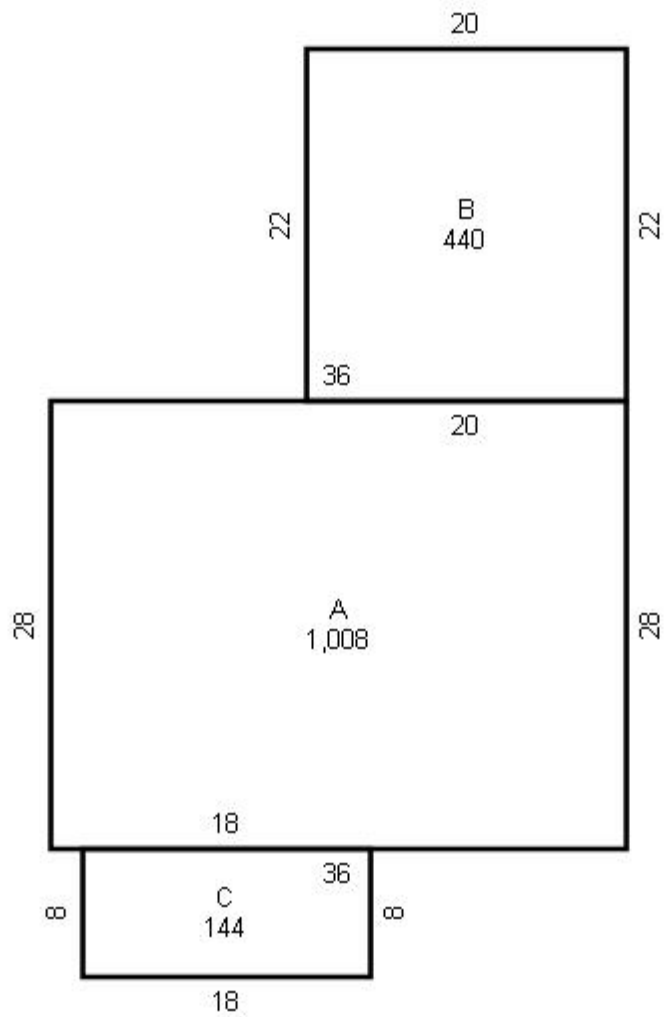

Name	Description	Size (Sqft)
	Total Sqft.	